

**'ROOF PLAN**

MEDEL · MESICK · COHEN · WAITE · HALL · ARCHITECTS  
 388 BROADWAY  
 ALBANY, NEW YORK 12207

RESTORATION OF  
**ONTARIO COUNTY COURT HOUSE**  
 CANANDAIGUA, NEW YORK

1/4" SCALE  
 COMMISSION NO. 25202  
 DRAWN BY N.R.H.  
 DATE APRIL 1966  
 REVISED

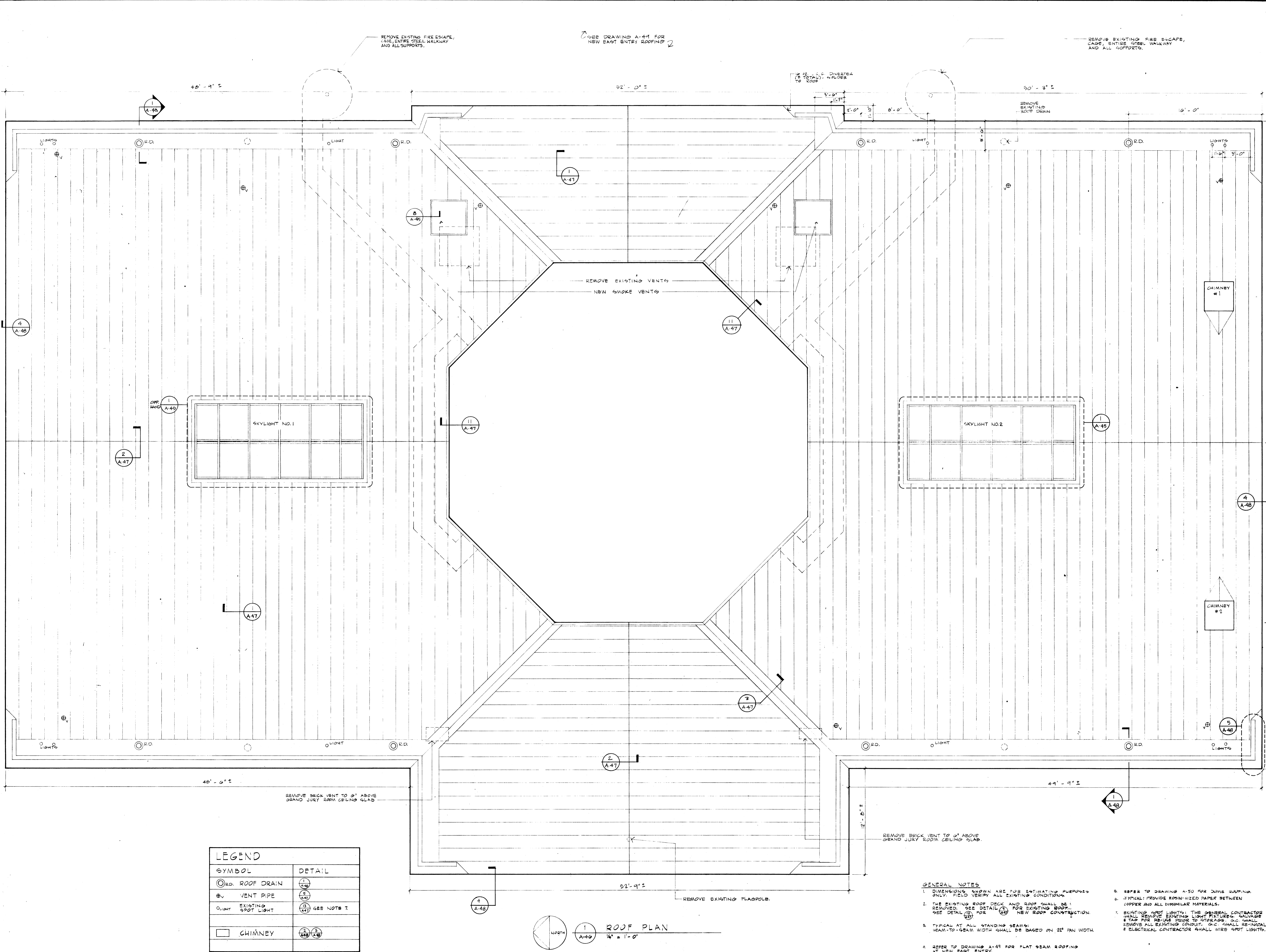

LEGEND	
SYMBOL	DETAIL
○ R.D.	1 ROOF DRAIN
⊕	2 VENT PIPE
○ LIGHT	3 SEE NOTE 7
□	4 CHIMNEY

1 ROOF PLAN  
 1/4" = 1'-0"

- GENERAL NOTES**
- DIMENSIONS SHOWN ARE FOR ESTIMATING PURPOSES ONLY. FIELD VERIFY ALL EXISTING CONDITIONS.
  - THE EXISTING ROOF DECK AND ROOF SHALL BE REMOVED. SEE DETAIL (1) FOR EXISTING ROOF. SEE DETAIL (2) FOR NEW ROOF CONSTRUCTION.
  - TYPICAL AT ALL STANDING SEAMS: SEAM-TO-SEAM WIDTH SHALL BE BASED ON 22" PAN WIDTH.
  - REFER TO DRAWING A-41 FOR FLAT SEAM ROOFING AT NEW EAST ENTRY.
  - REFER TO DRAWING A-50 FOR DOME ROOFING.
  - TYPICAL PROVIDE ROBIN-EED PAPER BETWEEN COPPER AND ALL DISSIMILAR MATERIALS.
  - EXISTING SPOT LIGHTS: THE GENERAL CONTRACTOR SHALL REMOVE EXISTING LIGHT FIXTURES, SALVAGE A TAP FOR REUSE CLOSE TO SPOTLAMP. G.C. SHALL REMOVE ALL EXISTING CONDUIT. G.C. SHALL RE-INSTALL ELECTRICAL CONTRACTOR SHALL WIRE SPOT LIGHTS.